

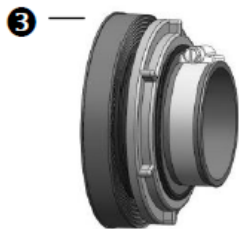

“Better By Design”

B Series Single Sided Threaded Penetration Fittings

TECHNICAL DATA SHEET

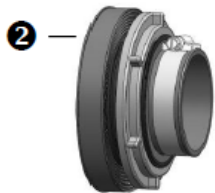

These unique penetrations require only one hole (hole saw size follows product number – B2 requires a 2” hole saw, etc.) The seal is molded into the body and has a conical shape allowing the penetration to seal to flat and curved surfaces.

Threaded penetrations are available for conduit sizes from 1/2” nominal pipe through 4” LCX pipe.

- 1 B2 penetrations typically are used on 1/2” through 1” rigid conduits.
- 2 B3.5 penetrations are used on pipes 1 1/2” nominal through 2” LXC and 75mm pipe.
- 3 B5 penetrations are typically used on 2” nominal and 3” LCX.

Penetrations are shipped with Series 300 all stainless clamps.

Bodies and nuts are manufactured out of injection molded then CNC machined Acetal. The boot and seal are injection molded, UV resistant Alcryn.

Dimensional Data and Product Numbers on Reverse

Single Sided Threaded Penetration Fitting Dimensional Data

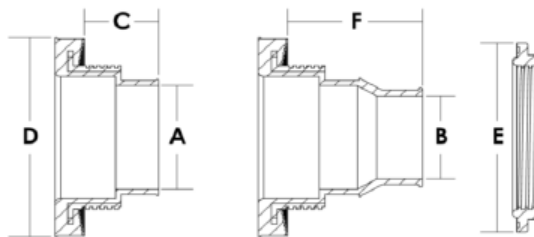

Part Number	A	B	C	D	E	F
SS1075	36.8/27.9	N/A	44.5	76.8	74.9	N/A
SS1100	36.8	N/A	44.5	76.8	74.9	N/A
SS1200F	63.5	N/A	61.0	127.6	114.3	N/A
SS1250F	76.2	N/A	63.5	165.1	156.2	N/A
SS1300F	91.4	N/A	63.5	165.1	156.2	N/A



“Better By Design”

Inverted Single Sided Studded Penetration Fittings

TECHNICAL DATA SHEET

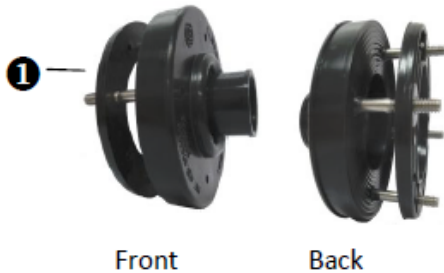

Inverted studded penetration fittings include a flexible back plate that seals on flat or curved surfaces, to 24” in diameter. These penetrations are secured with acetal molded stud nuts on the exterior of the sump. This eliminates having the stainless studs or nuts exposed to the soil. Boot material is UV resistant Alcryn injectible moldable rubber. Assembly includes Series 300 all stainless clamps. Front and back plates are manufactured out of Acetal.



1 4 Stud penetrations are available in 3/4” and 1” rigid conduit sizes.



2 8 Stud penetrations are available for 1.5” OD pipes through 3” nominal pipe.



3 10 Stud penetrations are available for 3” nominal pipe through 5.0” OD pipe. 10 Stud penetrations are also used on corrugated chase pipe.

4 12 Stud penetrations are available for 5.2” OD through 6” nominal pipe.

Series 300 stainless clamp and external stud nuts provided with each penetration.

Dimensional Data and Product Numbers on Reverse



Stainless Clamp and Stud Nuts are Included with Each Penetration

Inverted Single Sided Studed Penetration Dimensional Data

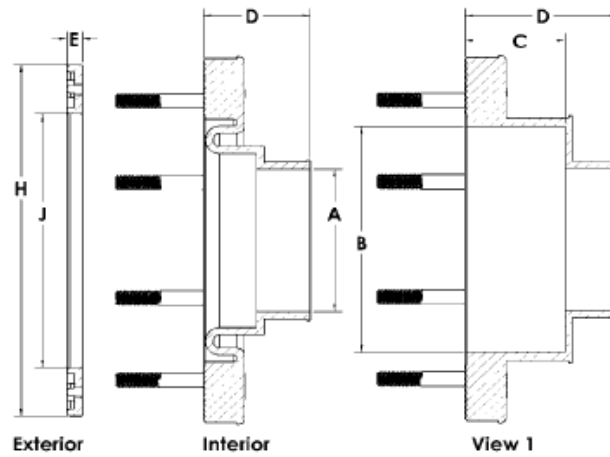

Part Number	A	B	C	D	E	H	J
SS1200B	64.8	N/A	N/A	41.3	6.4	161.9	134.2
SS1250B	77.0	N/A	N/A	41.3	6.4	161.9	134.2
SS1300B	91.4	N/A	N/A	42.2	6.4	203.2	174.6
SS1400B	115.6	N/A	N/A	42.2	6.4	203.2	174.6
SS1500B	128.3	N/A	N/A	42.2	6.4	203.2	174.6
SS1600B	161.3	N/A	N/A	45.2	6.4	235.0	204.8



“Better By Design”

Terminating and Test Reducers

TECHNICAL DATA SHEET

- 1 Terminating reducers are used to terminate the secondary pipe to the primary pipe in a double wall piping system. Test reducers do the same with an air test valve.
- 2 Diversified Test Reducers incorporate a ‘molded in’ brass air test valve manufactured in the US by Diversified. Both terminating and test reducers are injection molded out of UV resistant Alcryn melt processable rubber and are suitable for testing up to 35 PSIG. Product numbers ending in ‘A’ include a test valve.
- 3 Series 300 stainless worm gear clamps allow testing to 10 PSIG. Optional tee handle clamps (designated ‘HP’) allow the reducer to be tested to 35 PSIG. Typical product number for a high pressure boot would be RA 3.6x2.4HP.



Dimensional Data and Product Numbers on Reverse

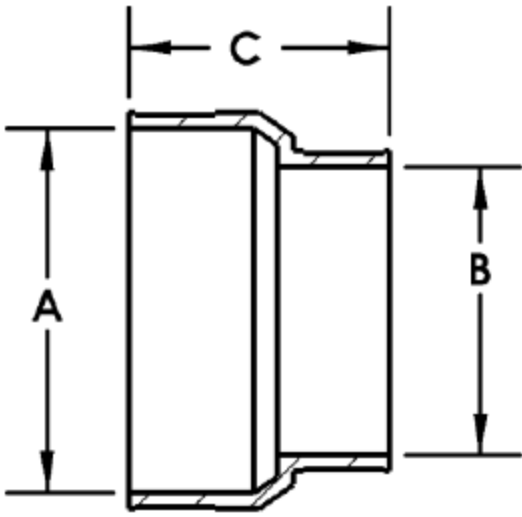

Part Number	A	B	C
SS4032	41.3	32.3	50.8
SS6350	64.8	52.7	73.7
SS7563	77.0	64.8	50.8